

MODEL 9502

9502

2/27/97

802005 AUXILIARY SPARES

802004 TOP LEVEL ASSEMBLY

801561 THERMAL PAPER KIT

9502 MAN 9502 MANUAL
222256 DISK, SUPPORT

220840 LOGO PLATE

222122 PAPER CAUTION LABEL

281116 (2) SOC HD 10-32X1/2

281120 (4) SOC HD 10-32X5/8

281612 (4) SOC HD 6-32X3/8

283320 (8) FLAT HD 6-32X1/4

288015 (6) WASHER, SPLIT #10

288034 (4) WASHER, FLAT SM. #10

288061 (4) WASHER, NYLON, .03 #6

288073 (2) WASHER, NYLON, .05 #10

549021 LOCTITE

801995 CASE ASSEMBLY

220153 (2) SERIAL NO. LABEL

220442 (2) SKID

221880-002 MAIN CASE

221920-002 COVER PLATE, MARKED

221922-002 COVER PLATE, MARKED

221977-022 VIEW PANEL, LG. THERM

221981(2) BRACKET, CONTROL PANEL

222067-022 FEED ROLL COVER, PAINT

262001-026(2) FINGER GUARD

281116 (4) SOC HD 10-32X1/2

281612 (8) SOC HD 6-32X3/8

283320 (4) FLAT HD 6-32DX1/4

288015 (8) WASHER SPLIT #10

288032 (12) WASHER FLAT SM. #6

288034 (8) WASHER FLAT SM. #10

289552 (2) RCN 105SL 125

549021 LOCTITE

281120 (4) SOC HD 10-32 X 5/8

288063 (12) NYLON WASHER #6

255035 PLASTIC EDGE PROTECTOR

801746 (2) BRACKET ASSY

221981 BRACKET
289552 RCN 105SL

802006 FINAL ASSEMBLY 9502

(SEE PAGE 2)

SPARES & MISC	DESCRIPTION
ND-802246	SMALL SPARES
ND-802009	DEPOT SPARES
801624	THERMAL FILM KIT
801561	THERMAL PAPER KIT

SCHEMATIC #	PART NO.	DESCRIPTION
900467	801977	CONTROL BOARD
900468	802007	MICRO BOARD
NO SCHM	801719	IEEE BOARD
900452	801817	POWER PC BOARD

EPC

EPC LABS DANVERS

TITLE:
9502 TREE

DRAWN BY: JUDE GARLINGTON DATE: 2/27/97

REV: B

FINAL ASSEMBLY 802006

9502

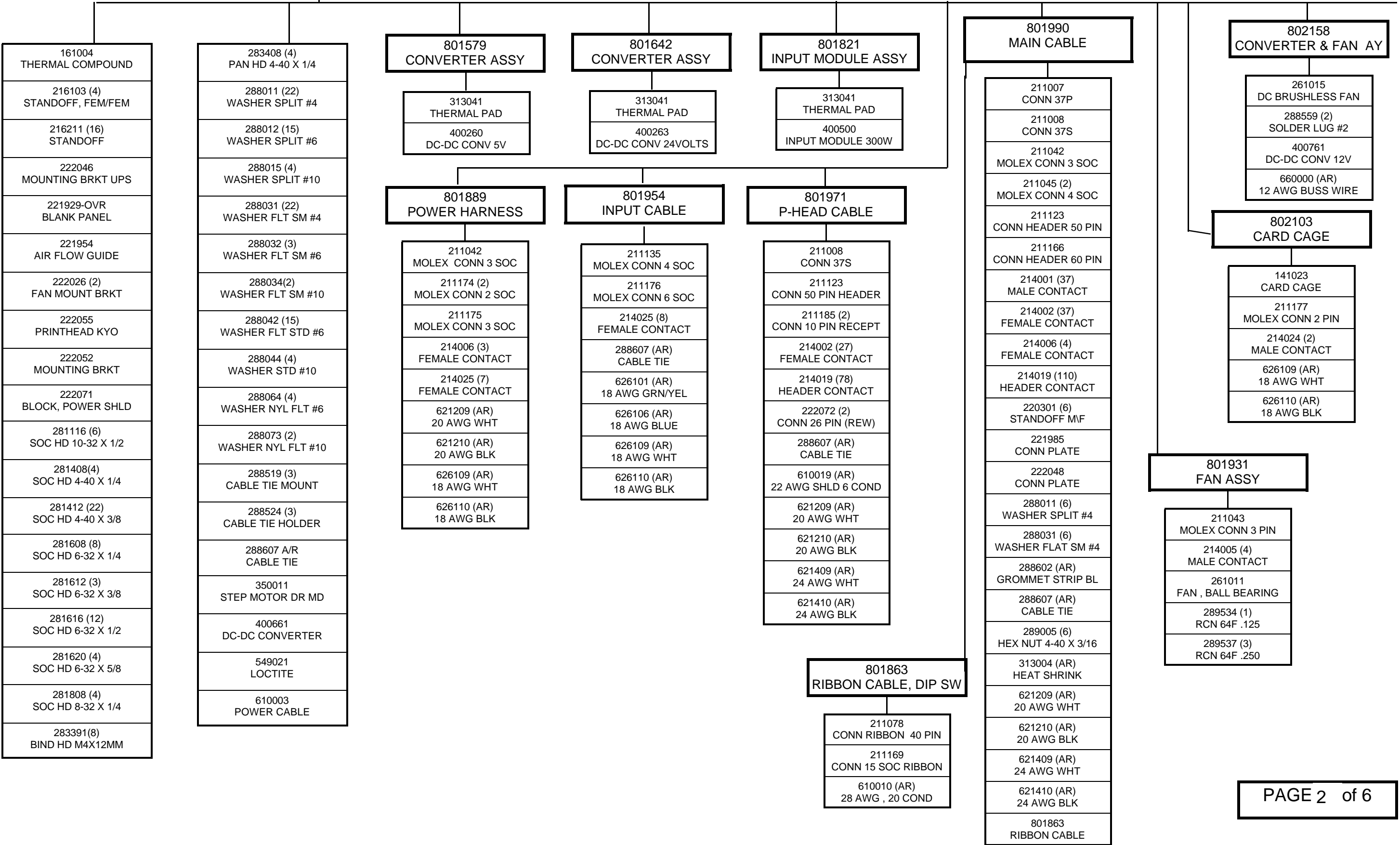

802006
FINAL ASSY (CONT)

9502

801670
CONTROL PANEL AY

- 221934-OVR PANEL
- 246513 IND LAMP, WHT
- 246514 (3) IND LAMP, RED 6V
- 246515 IND LAMP, WHT 24V
- 281406 (2) SOC HD 4-40 X 3/16
- 288011 (2) WASHER SPLIT #4
- 288041 (2) WASHER FLAT #4
- 288524 CABLE TIE HOLDER
- 288564 SOLDER LUG #4
- 288607 (AR) CABLE TIE
- 471137 RES 2.0K OHM AT 1/2W
- 516516 SWITCH
- 516517 switch
- 516518 (2) SWITCH
- 516523 switch
- 621410 (AR) 24 AWG BLK

801691
CABLE ASSY

- 211007 CONN 37 PIN
- 212004 HOUSING
- 213004 SCREW LOCK
- 214001 (15) MALE CONTACT
- 288564 SOLDER LUG #4
- 621210 (AR) 20 AWG BLK
- 621409 (AR) 24 AWG WHT
- 621410 (AR) 24 AWG BLK

801584
AUDIO ALARM BD

- 151028 CAP .01UF
- 151083 CAP 1.0UF
- 216070 (5) TURRET
- 246022 BUZZER
- 384000 IC HC7400
- 473018 RES ARRAY 10K
- 480914 (3) DIODE
- 700089 PC BOARD

802151
CONN PLATE AY

- 211175 MOLEX CONN 3 SOC
- 213032 SCREW LOCK
- 214025 (3) FEMALE CONTACT
- 216200 BINDING POST
- 221936-OVR CONN PLATE
- 270009 LINE FILTER
- 281408 (2) SOC HD 4-40 X 1/4
- 283312 (2) FLAT HD 4-40 X 1/2
- 288004 WASHER INT #8
- 288011 (4) WASHER SPLIT #4
- 288031 (2) WASHER FLAT #4
- 288560 SOLDER LUG #4
- 289005 (2) HEX NUT 4-40 X 3/16
- 515034 FUSE 3AMP
- 626101 (AR) 18 AWG GRN/YEL
- 626105 (AR) 18 AWGBROWN
- 626106 (AR) 18 AWG BLUE

800828
DIP SWITCH PC

- 516506 DIP SWITCH

800831
TURRET ASSY

- 216070 (9) TURRET
- 700046 PC BD

801891
POWER INPUT PC

- 151130 CAP 1000UF
- 211147 MOLEX CONN 4 PIN
- 211173 MOLEX CONN 3 PIN
- 215057 (7) SOCKET
- 215058 (2) SOCKET
- 700103 PC BD

801658
RIBBON CABLE ASSY

- 211082 RIBBON CONN 26 PIN
- 211084 RIBBON CONN 25 PIN
- 213037 POLARIZING KEY
- 610005 (AR) 28 AWG 26 COND

801843
CABLE ASSY,C PL

- 211003 CONN 15 PIN
- 212002 HOUSING
- 213004 SCREW LOCK
- 214001 (9) MALE CONTACT
- 621409 (AR) 24 AWG WHT
- 621410 (AR) 24 AWG BLK

801817
UNIV POWER PC BD

- 151069 CAP .22UF
- 151086 (4) CAP 1MF
- 151123 (3) CAP 1000UF
- 151131 CAP 11,000UF
- 211144 (2) CONN HEADER 50 PIN
- 211146 (2) MOLEX CONN 2 PIN
- 211172 MOLEX CONN 6 PIN
- 211173 MOLEX CONN 3 PIN
- 215042 SOCKET 16 PIN
- 215057 (28) SOCKET
- 215058 (8) SOCKET
- 216026 CRIMP LUG #8
- 216208 (5) TEST POINT JUMPER
- 283408 (4) PAN HD 4-40 X 1/4
- 313002 (AR) HEAT SHRINK
- 361111 IC DM74123N

- 370026 OPTIC ISOLATOR
- 471009 RES 270 OHMS 1/8 W
- 471016 RES 1K OHMS 1/8 W
- 471025 RES 4.7K OHMS 1/8W
- 471030 RES 8.2K OHMS 1/8W
- 471044 (2) RES 36K OHMS 1/8W
- 471048 RES 47K OHMS 1/8W
- 471055 RES 100K OHMS 1/8W
- 471179 RES 470K OHMS 1/2W
- 471265 RES 200 OHM 5 WATT
- 472060 (4) POT 10K
- 481501 TRANS PAD
- 482222 TRANS 2N2222
- 484007 DIODE IN4007
- 484937 DIODE IN4937
- 700099 PC BD

802007
MICRO BD

- 171044 MICRO BD
- 201256 IC
- 201802 IC
- 202056 IC RAM
- 211182 (2) CONN HEADER LATCHING
- 216210 SPRING SHUNT

802008
PROGRAM

- 202512 EPROM I

801718
MICRO TO GPIB
CABLE

- 211079 HEADER CONN 26 PIN
- 211138 HEADER CONN 14 PIN
- 213037 POLARIZING KEY
- 214019 (39) HEADER CONTACTS
- 288607 (AR) CABLE TIE
- 621409 (AR) 24 AWG WHT
- 621410 (AR) 24 AWG BLK

801719
IEEE BOARD

- 171047 BOARD

9502

802006
FINAL ASSEMBLY (CONT)

801977
CONTROL BD

- 151028 (40)
CAP .01UF
- 151083
CAP 1.0UF
- 151088 (4)
CAP 4.7UF
- 200828
IC ADC 8 BIT
- 201254
IC
- 202120 (2)
IC 7C128A
- 211077
CONN HEADER 40 PIN
- 211179
CONN HEADER 60 PIN
- 215042 (4)
SOCKET 16 PIN
- 215043
SOCKET 24 PIN W
- 215046 (4)
SOCKET 14 PIN
- 215051 (10)
SOCKET 20 PIN
- 215052
SOCKET 28 PIN W
- 215053 (13)
SOCKET 24 PIN
- 215059 (4)
SOCKET 28 PIN
- 232823
OSC 33MHz
- 245011 (4)
LED, RED
- 245012
LED, GREEN
- 255037
EJECTOR HANDLE
- 364138 (2)
IC 74F138
- 364432
IC 74F32
- 364438
IC 74F38

- 364538
IC 74F538
- 384244
IC 74LS244
- 384245 (4)
IC 74LS245
- 384273 (2)
IC 74LS273
- 384367 (2)
IC 74LS367
- 384374 (2)
IC
- 384652 (4)
IC 74LSTTL
- 390490
IC
- 471032
RES 10K OHMS 1/8 W
- 471216
RES 1 OHMS 1/4 W
- 471409
RES 2.94K OHMS 1/8 W
- 471410
RES 11.8K OHMS 1/8 W
- 471415 (4)
RES 2K OHMS 1/8 W
- 471416 (4)
6.49K OHMS 1/8 W
- 472060
POT 10K
- 473015
RES ARRAY 10k
- 473016 (4)
RES ARRAY 1K
- 473017 (4)
RES ARRAY 10K
- 489000
IC MOSFET
- 700101
PC BD

- 801913
FAST PAL
203330
- 801914
RAM PAL
203210
- 801915
ADDRESS PAL
203610
- 801916
SHIFT PAL
203209
- 801917
SHADE PAL
203209
- 801918 (2)
COMP PAL
203331
- 801919
DEC PAL
203209
- 801920
CHART PAL
203331
- 801921
MISC PAL
203610
- 801922
STROBE PAL
203209

801972
POWER SHIELD

- 222070
SHIELD
- 255054 (AR)
EXTRUDED CHANNEL
- 281412 (2)
SOC HD 4-40 X 3/8
- 288011 (2)
WASHER SPLIT #4
- 288031 (2)
WASHER FLAT SM #4
- 288524 (AR)
CABLE TIE HOLDER
- 288607 (AR)
CABLE TIE

801975
P-HEAD LOCK CABLE

- 211044
MOLEX CONN 4 PIN
- 214005 (4)
MALE CONTACT
- 288607 (AR)
CABLE TIE
- 313004 (AR)
HEAT SHRINK
- 313007 (AR)
HEAT SHRINK
- 513008
MICRO SWITCH
- 621409 (AR)
24 AWG WHT
- 621410 (AR)
24 AWG BLK
- 641410 (AR)
24 AWG TW/PR BLK/WHT

801582
PAPER SENSOR AY

- 215039 (4)
SOCKETS
- 281412 (2)
SOC HD 4-40 X 3/8
- 288011 (2)
WASHER SPLIT #4
- 288031 (4)
WASHER FLAT #4
- 289050 (2)
HEX NUT 4-40 X 1/4
- 370025
OPTIC SENSOR
- 471009
RES 270 OHMS 1/8 W
- 471016
RES 1K OHMS 1/8 W
- 471055
RES 100K OHMS 1/8 W
- 480106
MOS FET

801588
TURRET ASSY

- 216070 (3)
TURRET
- 700088
PC BD

801907
TU MOTOR ASSY

- 151086
CAP 1MF
- 211044
MOLEX CONN 4 PIN
- 214005 (2)
MALE CONTACT
- 222044
ADAPTER PLATE
- 222047
MOTOR
- 283372 (3)
FLAT HD 4-40 X 1/4
- 288563
SOLDER LUG #10
- 288607 (AR)
CABLE TIE
- 313004 (AR)
HEAT SHRINK
- 621210 (AR)
20 AWG BLK
- 641208 (AR)
20 AWG TW GRY/WHT

802006
FINAL ASSEMBLY (CONT)

MAIN FRAME ASSEMBLY 801989

9502

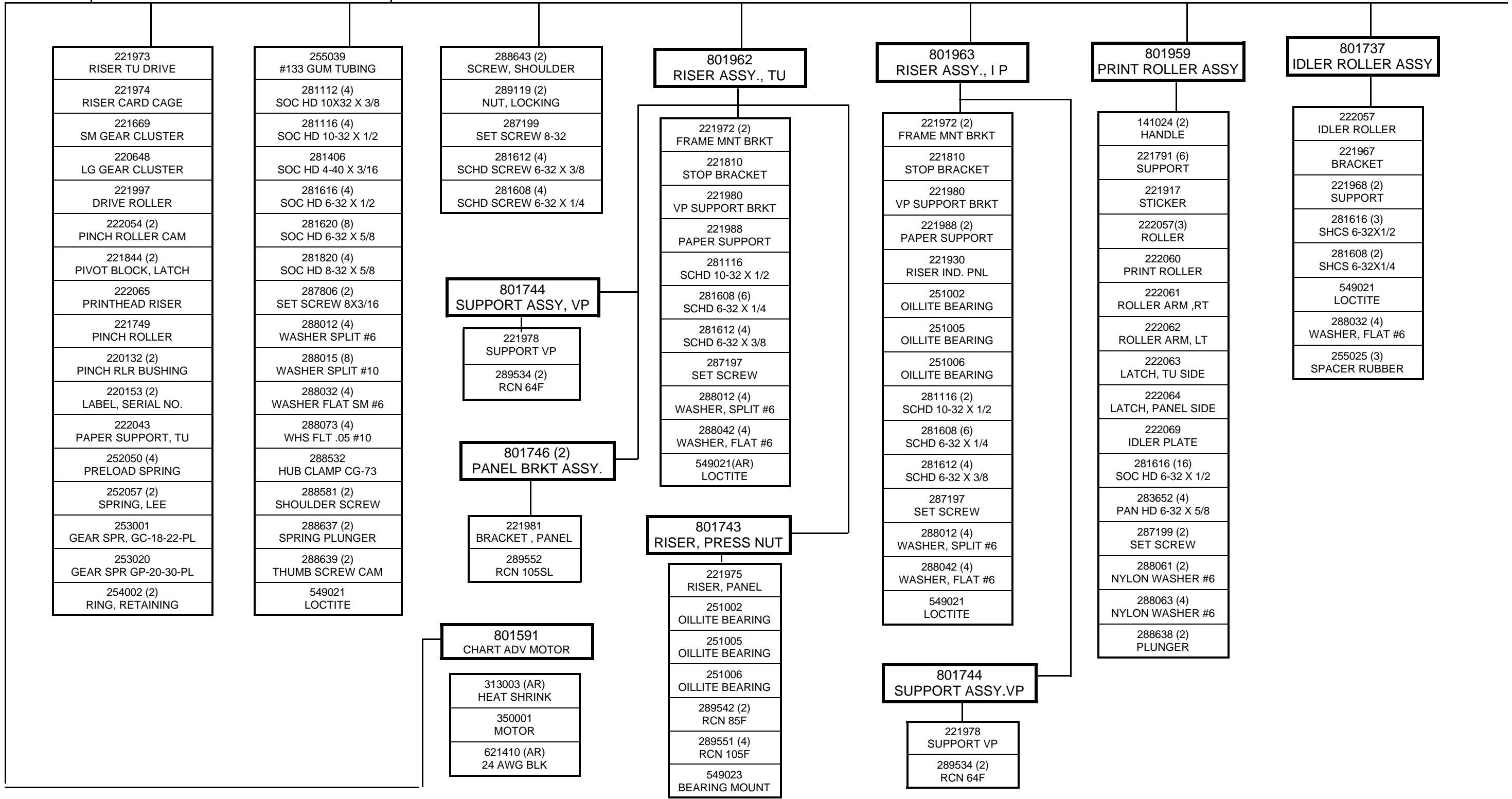

REV	DESCRIPTION	ECO
A	ADDED 201256 TO MICRO BD	1422
B	DELETED DISK 802383 AND ADDED 222256 SUPPORT DISK	1521