

**MODEL 9802/ 9802 ST INCLUDES SHADED AREA PARTS**

3/19/97

801966  
AUXILIARY SPARES

141026  
TRANSPORT CASE

801965  
TOP LEVEL ASSEMBLY

801967  
SPARE PARTS KIT

801970  
CASE ASSEMBLY

801961  
FINAL ASSEMBLY 9802

(SEE PAGE 2)

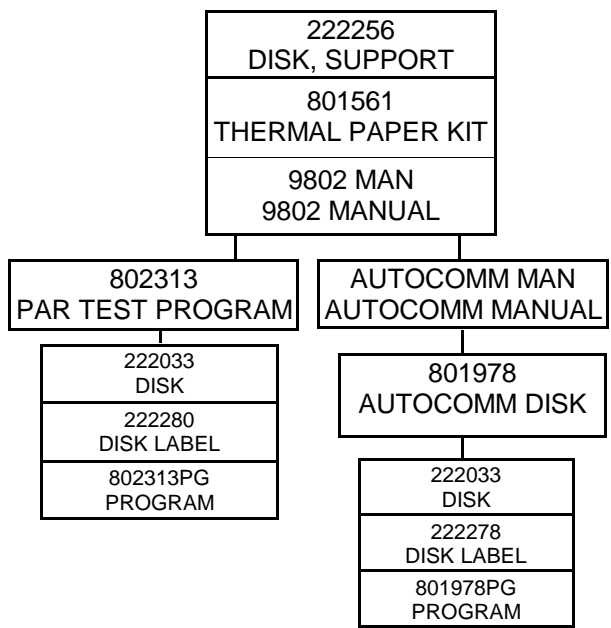

- 140001 LG CLEAR DIV BOX
- 140002 (4) SM CLEAR BOX
- 140003 LG CLEAR BOX
- 140008 ELEC COND BOX
- 151023 CAP .001UF
- 151069 CAP .22UF
- 151086 CAP 1MF
- 151122 CAP 470UF
- 151123 CAP 1000UF
- 246022 BUZZER
- 246024 (5) LAMP 6 VOLT
- 246025 (5) LAMP 12 VOLT
- 246026 (5) LAMP 24 VOLT
- 281116 (8) SOC HD 10-32 X 1/2
- 281120 (8) SOC HD 10-32 X 5/8
- 283320 (8) FLAT HD 6-32 X 1/4
- 288034 (8) WASHER FLAT #10
- 288073 (8) WASHER NYLON #10

- 288638 PLUNGER
- 384000 IC HC7400
- 384051 (2) IC
- 384156 IC 74LS156
- 393140 OP AMP CA3140
- 472015-020 POT 20K 10 TURN
- 472062 POT 1K
- 472063 POT 10K
- 480200 (2) DIODE
- 485406 (4) DIODE IN5406
- 515034 (5) FUSE 3 AMP
- 515151 (2) CURRENT LIMITER
- 516519 SWITCH
- 516520 (2) SWITCH
- 516521 SWITCH
- 516522 SWITCH
- 540011 HEX WRENCH SET
- 549006 LAMPING TOOL

- 220840 LOGO PLATE
- 222122 PAPER CAUTION LABEL
- 281116 (2) SOC HD 10-32X1/2
- 281120 (4) SOC HD 10-32X5/8
- 281612 (8) SOC HD 6-32X3/8
- 288015 (4) WASHER, SPLIT #10
- 288034 (6) WASHER, FLAT SM. #10
- 288042 (8) WASHER FLAT #6
- 288061 (8) WASHER, NYLON, .03 #6
- 288073 (2) WASHER, NYLON, .05 #10

- 801955 ANALOG BOARD
- 801968 MICRO BOARD
- 801977 CONTROL BOARD

SEE PAGES 3, 4, + 5

- 212006 (8) BNC COVER
- 220153 (2) SERIAL NO LABEL
- 220442 (2) SKID
- 221880-002 MAIN CASE
- 221920-002 COVER PLATE
- 221977-022 VIEW PANEL
- 222067-022 FEED ROLL COVER
- 255035 EDGE PROTECTOR
- 262001-026(2) FINGER GUARD
- 281116 (4) SOC HD 10-32X1/2
- 281612 (4) SOC HD 6-32X3/8
- 283320 (8) FLAT HD 6-32DX1/4
- 288015 (4) WASHER SPLIT #10
- 288032 (4) WASHER FLAT SM. #6
- 288034 (4) WASHER FLAT SM. #10
- 288064 (4) NYLON WASHER #6
- 549021 LOCTITE

SPARES & MIS	DESCRIPTION
ND-801967	SMALL SPARES W/BDS
ND-802112	SMALL SPARES WO/BDS
ND-801984	DEPOT SPARES
801624	THERMAL FILM KIT
801561	THERMAL PAPER KIT
801978	AUTOCOM SOFTWARE PROGRAM
801671 (OPTIONAL)	IEEE-488 BD

SCHEMATIC #	PART NO.	DESCRIPTION
900477	801977	CONTROL BOARD
900468	801968	MICRO BOARD
900435	801523	DIGITAL BOARD
900464	801955	ANALOG BOARD
900452	801817	POWER PC BOARD
NO SCHM	801671	IEEE BOARD

- 801746 (2) BRACKET ASSY
- 221981 BRACKET
- 289552 RCN 105SL

**EPC LABS DANVERS**

TITLE:  
9802 TREE

DRAWN BY: JUDE GARLINGTON      DATE: 3/23/2000

REV: J

**FINAL ASSEMBLY 801961**

**9802**

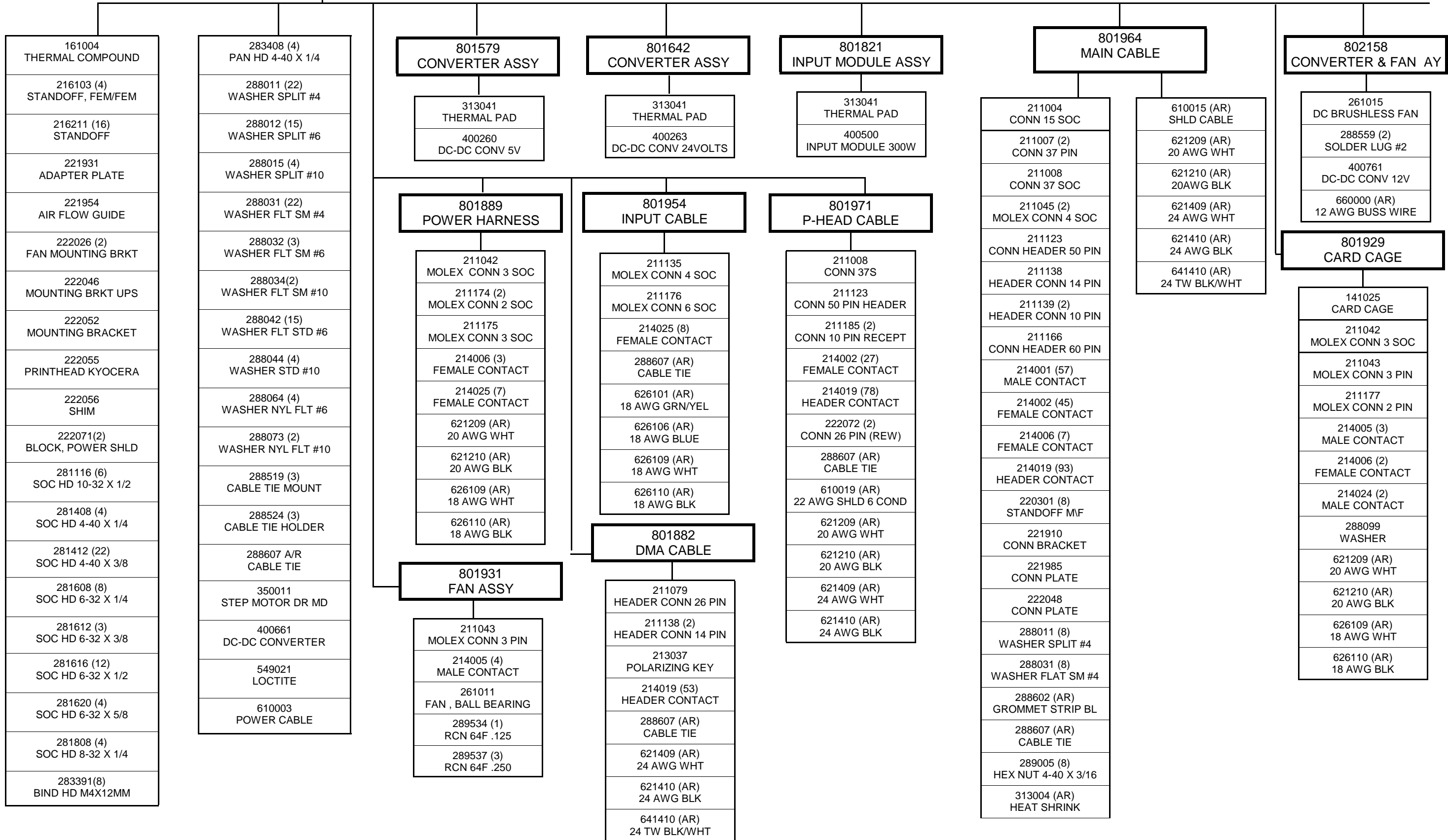

801961  
FINAL ASSY (CONT)

9802

801933  
CONTROL PANEL AY

- 211094 (5) CONN, LED
- 212004 HOUSING
- 213004 SCREW LOCK
- 221876-OVR PANEL
- 242007 (9) KNOB
- 242008 (2) KNOB, CONCENTRIC
- 242009 (2) KNOB 10 TURN
- 245002 (5) RED LED
- 288524 (2) CABLE TIE HOLDER
- 288558 SOLDER LUG #14
- 288607 (AR) CABLE TIE
- 472015-020 (2) POT, 10 TURN
- 472062 (3) POT 1K
- 472063 (2) POT/SWITCH 10 K
- 512038 (2) ROTARY SWITCH 8 POS
- 512039 (2) ROTARY SWITCH 10 POS
- 516519 SWITCH
- 516520 (4) SWITCH
- 516521 SWITCH
- 516522 (2) SWITCH
- 621410 (AR) 24 AWG BLK

801661  
MULTIPLEXOR PC BD

- 151013 (10) CAP .01UF
- 151028 CAP .01UF
- 151083 (4) CAP 1.0UF
- 211167 HEADER CONN 60 PIN
- 215042 (6) SOCKET 16 PIN
- 215046 SOCKET 14 PIN
- 215051 SOCKET 20 PIN
- 216208 TEST POINT
- 246022 BUZZER
- 384000 IC HC7400
- 384051 (5) IC
- 384156 IC 74LS156
- 393140 OP AMP CA3140
- 473015 (2) RES ARRAY 10K 6 PIN
- 473018 RES ARRAY 10K 8 PIN
- 512036 (2) ROTARY SWITCH
- 700094 PC BOARD

801781  
CABLE ASSY

- 211007 CONN 37 PIN
- 211166 HEADER CONN 60 PIN
- 214001 (37) MALE CONTACT
- 214019 (56) HEADER CONTACT
- 621210 (AR) 20 AWG BLK
- 621409 (AR) 24 AWG WHT
- 621410 (AR) 24 AWG BLK

801780  
CABLE ASSY

- 211008 CONN 37 SOC
- 212004 HOUSING
- 213004 SCREW LOCK
- 214002 (37) FEMALE CONTACT
- 621210 (AR) 20 AWG BLK
- 621409 (AR) 24 AWG WHT
- 621410 (AR) 24 AWG BLK
- 641410 (AR) 24 TW BLK/WHT

801976  
DIP SWITCH PC

- 216070 (9) TURRET
- 516506 DIP SWITCH
- 700104 PC BD

801647  
CONN PLATE AY

- 211006 CONN 25 SOC
- 211051 (8) BNC CONN
- 220301 (4) SCREW LOCK
- 214002 (25) FEMALE CONTACT
- 221904-OVR CONN PLATE
- 222208 IEEE COVER PLATE
- 281408 (2) SOC HD 4-40 X 1/4
- 281412 (2) SHCS 4-40 X 3/8
- 288011 (2) WASHER SPLIT #4
- 288031 (2) WASHER FLAT #4
- 288524 CABLE TIE HOLDER
- 288567 (7) SOLDER LUG 1497
- 288607 CABLE TIE
- 313002 (AR) HEAT SHRINK
- 515034 FUSE 3 AMP
- 621210 (AR) 20 AWG BLK
- 621410 (AR) 24 AWG BLK

801858  
PRINTER PORT CABLE

- 211005 CONN 25 PIN
- 211079 HEADER CONN 26 PIN
- 214001 (25) MALE CONTACT
- 214019 (25) HEADER CONTACT
- 621409 (AR) 24 AWG WHT
- 621410 (AR) 24 AWG BLK

801854  
CONN PLATE, LINE INPUT

- 216200 BINDING POST
- 222028-002 CONN PLATE
- 283312 (2) FLAT HD 4-40 X 1/2
- 288002 (2) WASHER INT #4
- 288011 (2) WASHER SPLIT #4
- 288560 SOLDER LUG #4
- 289005 (2) HEX NUT #4

801890  
PEM ASSY

- 211175 MOLEX CONN 3 SOC
- 214025 (3) FEMALE CONTACT
- 216222 (4) CRIMP LUG
- 270010 LINE FILTER
- 288560 SOLDER LUG #4
- 288607 (AR) CABLE TIE
- 313034 (AR) HEAT SHRINK
- 515034 FUSE 3 AMP
- 621410 (AR) 24 AWG BLK
- 626101 (AR) 18 AWG GRN/YEL
- 626109 (AR) 18 AWG WHT
- 626110 (AR) 18 AWG BLK

801631  
INDICATOR PANEL

- 221879-OVR PANEL
- 246513 (3) IND LAMP
- 246514 (3) IND LAMP
- 246515 IND LAMP
- 246516 (2) IND LAMP
- 288012 WASHER SPLIT #6
- 288042 WSHR FLAT #6
- 288524 CABLE TIE HOLDER
- 288561 SOLDER LUG #6
- 288607 (AR) CABLE TIE
- 289060 HEX NUT 6-32 X 5/16
- 471137 RES 2.0K OHM 1/2W
- 516518 SWITCH
- 621410 (AR) 24 AWG BLK

801779  
CABLE ASSY

- 211003 CONN 15 PIN
- 212002 HOUSING
- 213004 SCREW LOCK
- 214001 (15) MALE CONTACT
- 621209 (AR) 20 AWG WHT
- 621210 (AR) 20 AWG BLK
- 621409 (AR) 24 AWG WHT

801891  
POWER INPUT PC

- 151130 CAP 1000UF
- 211147 MOLEX CONN 4 PIN
- 211173 MOLEX CONN 3 PIN
- 215057 (7) SOCKET
- 215058 (2) SOCKET
- 700103 PC BD

801968  
MICRO BOARD

- 171044 BOARD
- 201256 IC
- 201802 IC MK48TO2
- 202056 IC RAM
- 211182 (2) CONN HEADER LATCHING
- 216210 (3) SPRING SHUNT

801969  
PROGRAM

- 202512 EPROM

801961  
FINAL ASSY (CONT)

9802

801523  
INTERFACE BD

151002 CAP 15PF
151008 (3) CAP 150PF
151013 (11) CAP .01UF
151028 (2) CAP .01UF
151031 CAP 47PF
151066 CAP .1UF
151083 (6) CAP 1.0UF
201252 IC
211143 HEADER CONN LATCHING
211182 CONN HEADER LATCHING
215042 (2) SOCKET 16 PIN
215046 (5) SOCKET 14 PIN
215051 (4) SOCKET 20 PIN
215052 SOCKET 28 PIN W
215053 (4) SOCKET 24 PIN
216208 TEST POINT JUMPER
231011 CRYSTAL 2.4576 MHZ
231012 CRYSTAL 16.000 MHZ
231014 CRYSTAL 5.24288 MHZ
255037 EJECTOR HANDLE

360031 IC
360032 IC
384000 IC HC7400
384244 (2) IC 74LS244
384245 IC 74LS245
384374 IC
384652 (2) IC 74LS245
387404 IC
387432 IC
471016 (8) RES 1K OHMS 1/8W
471032 RES 10K OHMS 1/8W
471055 RES 100K OHMS 1/8W
471061 (2) RES 2K OHM 1/8W
473017 (3) RES ARRAY 10K
700083 PC BOARD

801525  
DECODE PAL

203208 PAL
---------------

801880  
CONTROL PAL

203208 PAL
---------------

801817  
UNIV POWER PC BD

151069 CAP .22UF
151086 (4) CAP 1MF
151123 (3) CAP 1000UF
151131 CAP 11,000UF
211144 (2) CONN HEADER 50 PIN
211146 (2) MOLEX CONN 2 PIN
211172 MOLEX CONN 6 PIN
211173 MOLEX CONN 3 PIN
215042 SOCKET 16 PIN
215057 (28) SOCKET
215058 (8) SOCKET
216026 CRIMP LUG #8
216208 (5) TEST POINT JUMPER
283408 (4) PAN HD 4-40 X 1/4
313002 (AR) HEAT SHRINK
361111 IC DM74123N

370026 OPTIC ISOLATOR
471009 RES 270 OHMS 1/8 W
471016 RES 1K OHMS 1/8 W
471025 RES 4.7K OHMS 1/8W
471030 RES 8.2K OHMS 1/8W
471044 (2) RES 36K OHMS 1/8W
471048 RES 47K OHMS 1/8W
471055 RES 100K OHMS 1/8W
471179 RES 470K OHMS 1/2W
471265 RES 200 OHM 5 WATT
472060 (4) POT 10K
481501 TRANS PAD
482222 TRANS 2N2222
484007 DIODE IN4007
484937 DIODE IN4937
700099 PC BD

801891  
POWER INPUT PC BD

151130 CAP 1000UF
211147 MOLEX CONN 4 PIN
211173 MOLEX CONN 3 PIN
215057 (7) SOCKET
215058 (2) SOCKET
700103 PC BOARD

801955 (2)  
ANALOG BOARD

151013 (26) CAP .01UF
151031 CAP 47PF
151066 (2) CAP .1UF
151083 (3) CAP 1.0UF
151092 (3) CAP 10UF
151095 CAP 22UF
200226 IC AD7226KN
200300 IC CA3300
200524 IC
201254 IC
202265 IC RAM
211162 HEADER CONN LATCHING
215022 (4) SOCKET 8 PIN
215042 (6) SOCKET
215043 SOCKET 24 PIN W
215045 SOCKET 18 PIN
215051 (4) SOCKET 20 PIN
215059 SOCKET 28 PIN

215068 (2) SOCKET 68 PIN
216208 TEST POINT
255037 EJECTOR HANDLE
384060 IC 74HC4060
384244 IC 74LS244
384245 (2) IC 74LS245
384367 IC 74LS367
384592 IC 74HC592
390211 IC ADG211AKN
390311 IC LM311
390524 IC AD524
390744 IC
390746 (2) OP AMP AD746JN
450003 (3) RELAY
471009 RES 270 OHM 1/8W
471012 RES 470 OHM 1/8W
471016 (4) RES 1K OHM 1/8W
471023 RES 3.9K OHM 1/8W

471032 (4) RES 10K OHM 1/8W
471055 RES 100K OHM 1/8W
471063 (2) RES 5.1K OHM 1/8W
471065 RES 200K OHM 1/8W
471110 RES 220 OHM 1/2W
471215 RES 47 OHM 1/4W
471402 (3) RES 20K OHM 1/8W
471409 RES 2.94K OHM 1/8W
471413 RES 2.2K OHM 1/8W
471414 (2) RES 1.8K OHM 1/8W
471415 (8) RES 2.0K OHM 1/8W
472057 TRIMPOT 1K
473017 (2) RES ARRAY 10K
480085 (4) DIODE BAT85
480624 DIODE
480751 DIODE IN751A
516506 DIP SWITCH
700092 PC BOARD

801615  
DECODE PAL

203810 PAL
---------------

801618  
TIMING PAL

203810 PAL
---------------

801907  
TU MOTOR AY

151086 CAP 1MF
211044 MOLEX CONN 4 PIN
214005 (2) MALE CONTACT
222044 ADAPTER PLATE
222047 TU MOTOR
283372 (3) FLAT HD 4-40 X 1/4
288563 SOLDER LUG #10
288607 (AR) CABLE TIE
313004 (AR) HEAT SHRINK
621210 (AR) 20 AWG BLK
641208 (AR) 20 AWG TW GRY/WHT

801961  
FINAL ASSEMBLY (CONT)

9802

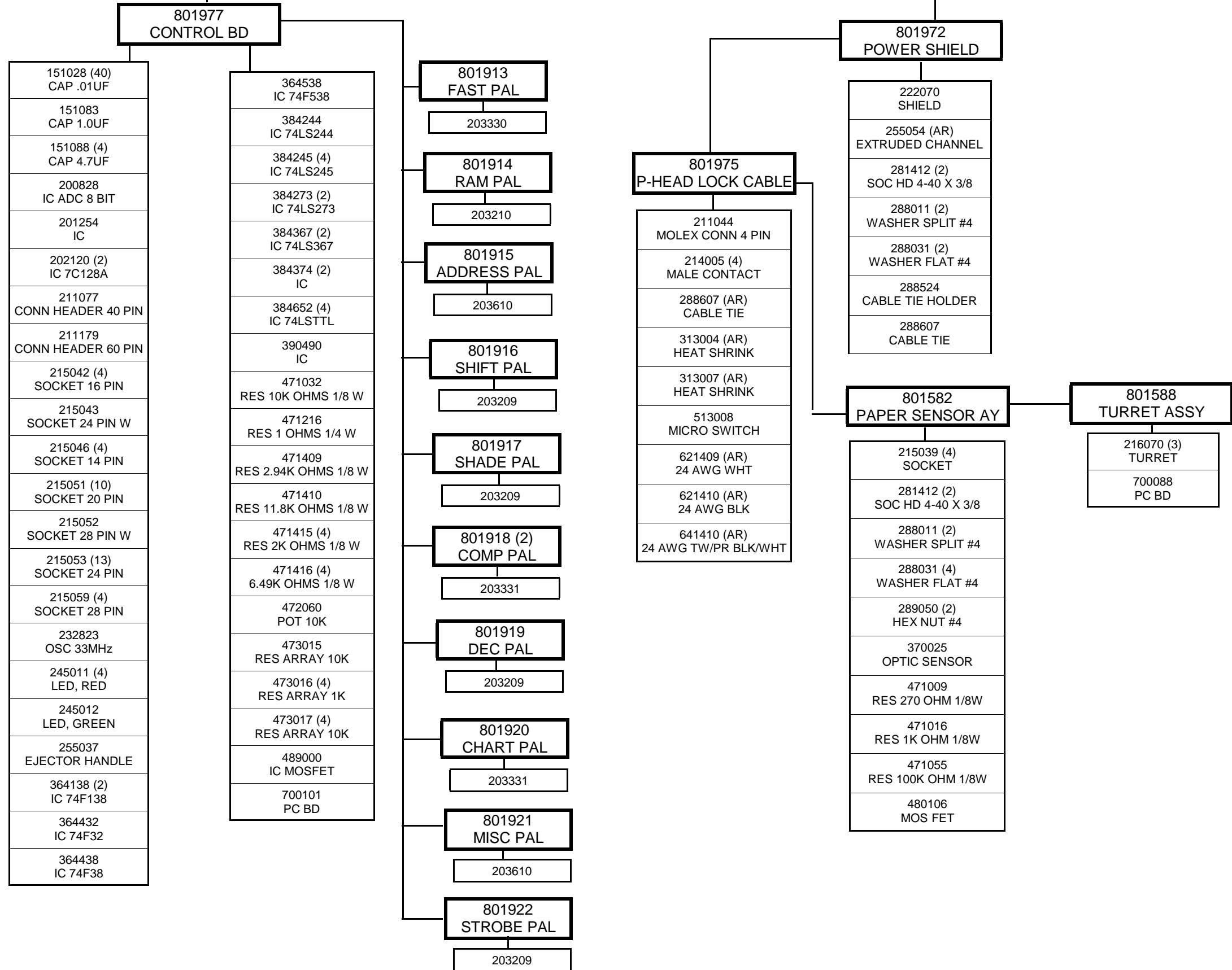

801961

MAIN FRAME ASSEMBLY 801989

9802

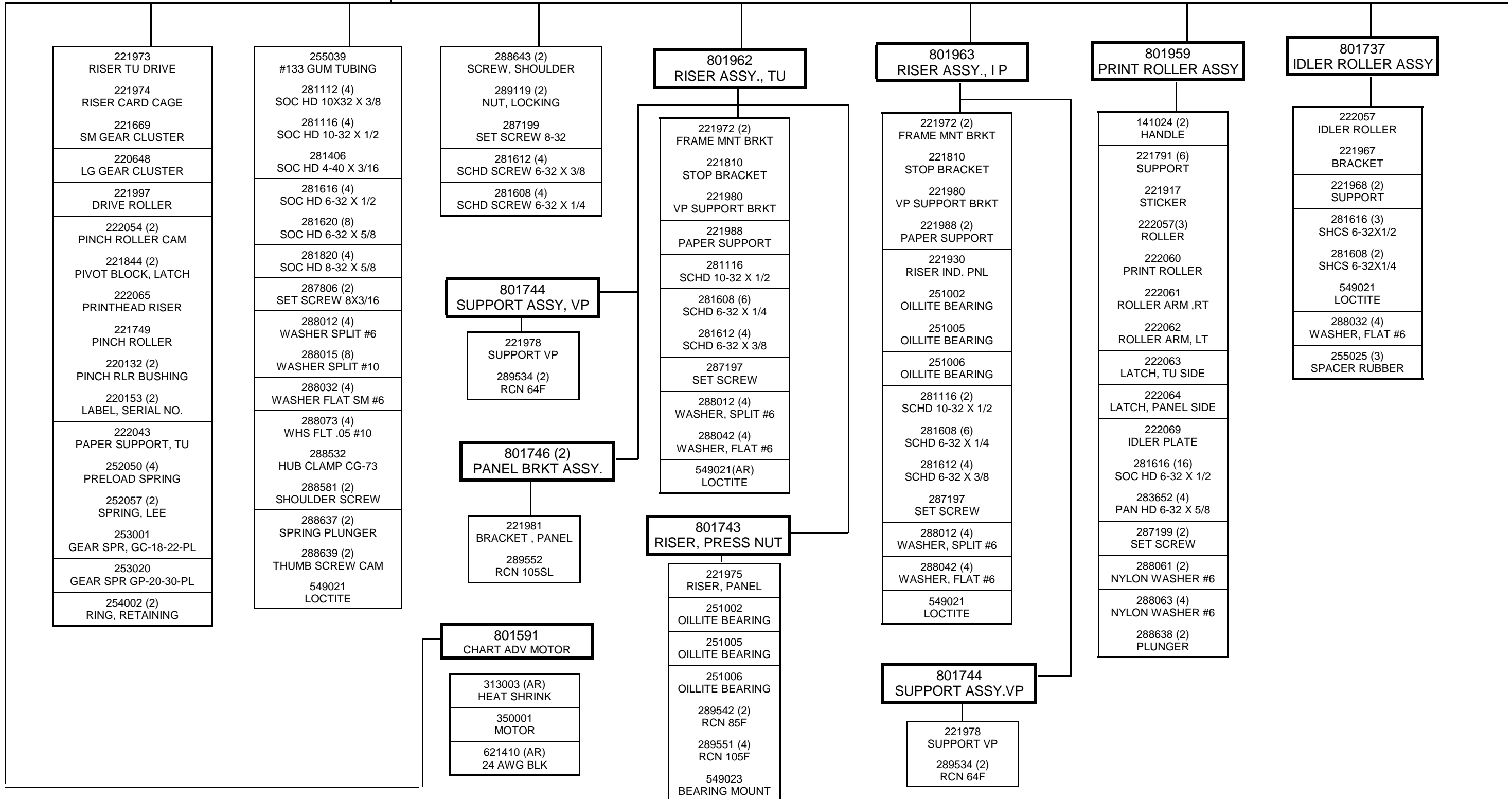

REV	DESCRIPTION	ECO
A	ADDED PARALLEL TEST DISK TO MANUAL	1392
B	ADDED 222208 COVER PLATE TO C.PLATE / REMOVAL OF IEEE BD	1403 + 1408
C	ADDED 201256 TO MICRO BD	1422
D	CHANGED 213003 TO 220301/ADDED 281412/ REDUCED 281408 QTY FROM 4 TO 2/ TO C. PLATE 801647	1438
E	ADDED 802383 DISK, DEMO IPU	1443
H	DELETED 802383 DISK AND ADDED 222256 SUPPORT DISK	1522
I	ADDED M9802 ST	1544
J	ADDED NEW STRUCTURE FOR MANUALS	1550